

The Name of Reliability

Autonics

Sensors, Controllers & More

Control Switches



Momentary Push Buttons

- » Momentary Push with single NO contact
- » Flush Mount Accessory and Water Proof Protector available

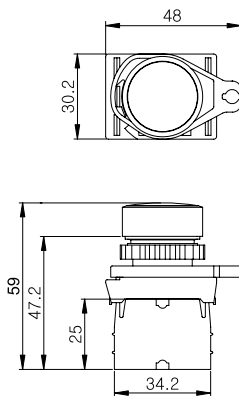

MC2 - P R - A

CONTACT BLOCK	
A	110/220V AC, NO
COLOR	
R	RED
Y	YELLOW
G	GREEN
B	BLUE
K	BLACK
STYLE	
P	Momentary Push Button

Illuminated Push Buttons

- » Momentary Push with single NO contact
- » AC/DC LED configuration in various colors
- » Flush Mount Accessory and Water Proof Protector available

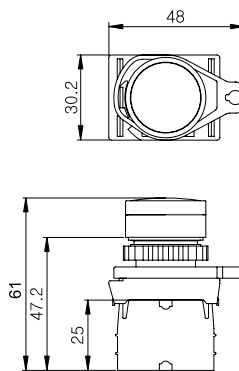

MC2 - LP R - AD

CONTACT BLOCK & LED	
AD	110/220V AC, NO Contact 12~30V DC/AC LED
AL	110/220V AC, NO Contact 110~220V AC LED
COLOR	
R	RED
Y	YELLOW
G	GREEN
B	BLUE
C	CLEAR
STYLE	
LP	Illuminated Push Button

Pilot Lamps

- » LED illumination with clear visibility
- » AC/DC LED configuration in various colors

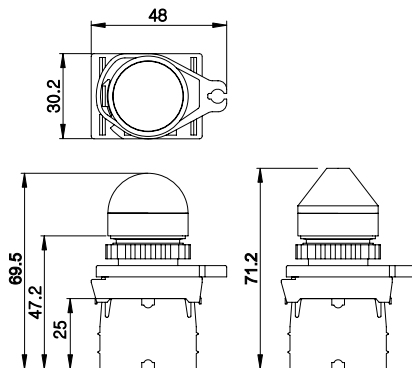

MC2 - PI D R - D

LED	
D	12~30V DC/AC LED
L	110~220V AC LED
COLOR	
R	RED
Y	YELLOW
G	GREEN
B	BLUE
C	CLEAR
HEAD STYLE	
D	Dome Head
H	Horn Head
F	Flush Head
STYLE	
PI	Pilot Lamp

Control Switches Ø22 & Ø25 Hole Mounted

Selector Switches

- » Available in 2 or 3 position selection
- » Fixed Position or Auto Position Return Styles



2 positions

3 positions

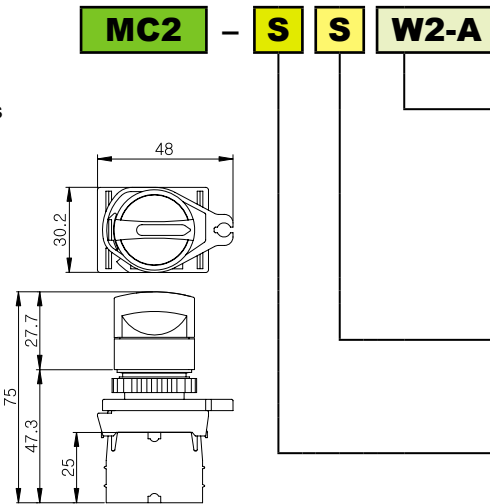
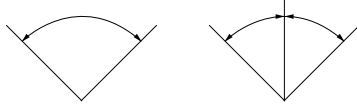

CONTACT BLOCK	
W2-A	2 Positions 110/220V AC Single NO contact
W3-AA	3 Positions 110/220V AC Double NO contacts
Selector Head	
S	Knob
L	Lever
STYLE	
S	Fixed Position Selector Switch
MS	Auto Position Return Selector Switch

Emergency Stops

- » Push Lock & Twist-to-release
- » Mushroom Style with illuminated or non-illuminated head

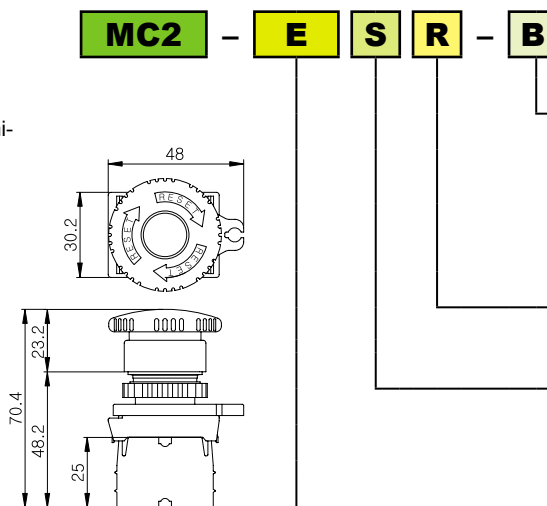

CONTACT BLOCK & LED	
B	110/220V AC, NC Contact
BD	110/220V AC, NC Contact 12~30V DC/AC LED
BL	110/220V AC, NC Contact 110~220V AC LED
COLOR	
R	RED
HEAD	
S	Small Head (Ø40mm)
L	Large Head (Ø60mm)
STYLE	
E	Emergency Stop
LE	Illuminated Emergency Stop





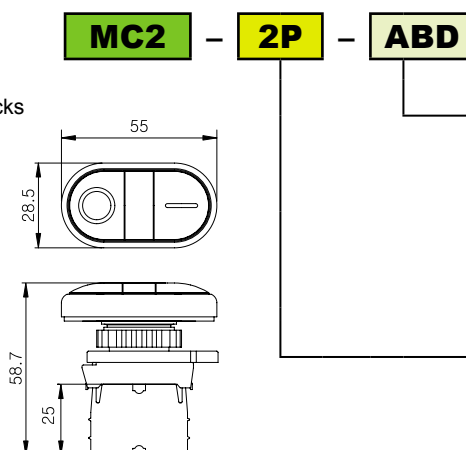

Double Push Buttons

- » Momentary Push with NO and NC contact blocks
- » LED illumination

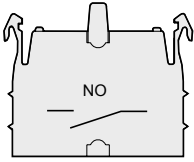

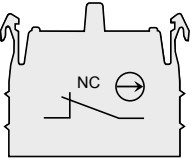
CONTACT BLOCK & LED	
ABD	110/220V AC, NO Contact 110/220V AC, NC Contact 12~30V DC/AC LED
ABL	110/220V AC, NO Contact 110/220V AC, NC Contact 110~220V AC LED
STYLE	
2P	Double Push Button

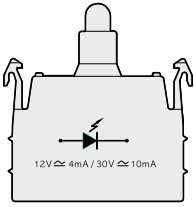
CONTACT BLOCKS & LEDS

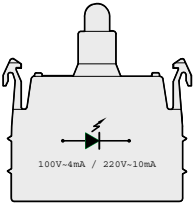
NO Contact Block	MC22-UA	NC Contact Block	MC22-UB	DC/AC LED	MC22-LWD	AC LED	MC22-LWA
 	 	 	 	110 VAC/ 10A, 220 VAC/ 5A		12~30 VDC/AC	
				110~220 VAC			

SPECIFICATIONS

Control Switches		Push Buttons	Illuminated Push Buttons	Pilot Lamps	Selector Switches	Emergency Stops	Double Push Buttons
Model		MC2-P	MC2-LP	MC2-PI	MC2-S	MC2-E	MC2-2P
Rated Voltage/ Current		Contact block: 110VAC/10A, 220VAC/5A			Contact block: 110VAC/10A, 250VAC/5A		
		—	LED: 12~30VAC/DC, 110~220VAC	—	LED: 12~30VAC/DC, 110~220VAC		
Life	LED	—	50,000 hours		—	50,000 hours	
	Mechanical	50,000 times (20times/min)					
	Electrical	100,000 times (20 times/min)					
Protection Degree		IP52					IP50
Initial Contact Resistance		20MΩ maximum					
Insulation Resistance		100MΩ minimum					
Operation Frequency		30 times/min maximum					
Impact	Endurance	500m/s ² minimum					
	No movement	100m/s ² minimum					
Vibration		10~55Hz with 3mm pick to pick					
Operating Temperature: -15~40 °C		Operating Humidity: 45~85%RH		Storage Temperature: -40~70 °C			